

# BRIGHTON DALE PARK FORCE MAIN REPLACEMENT

## FOR

# KENOSHA COUNTY, WISCONSIN

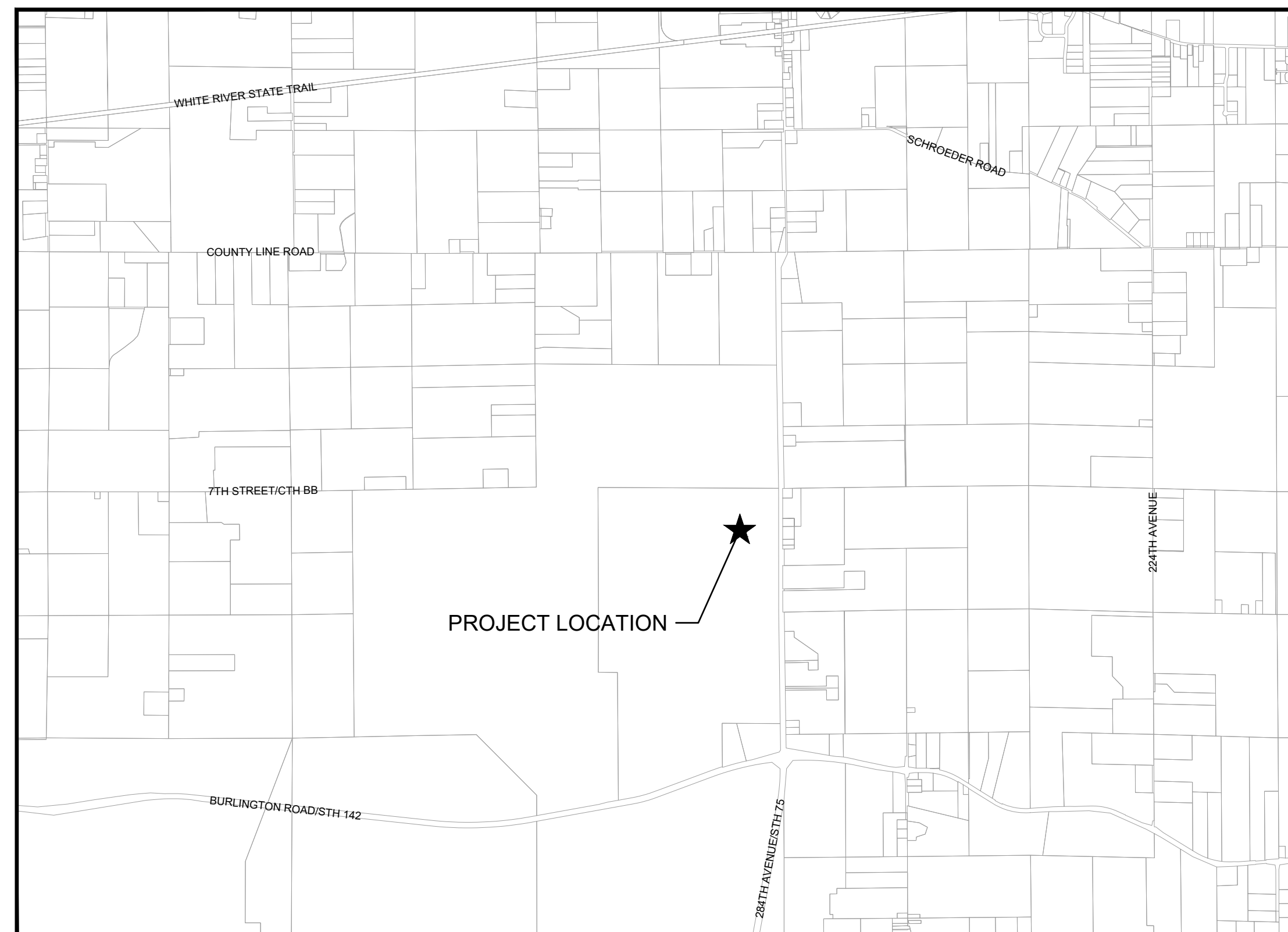
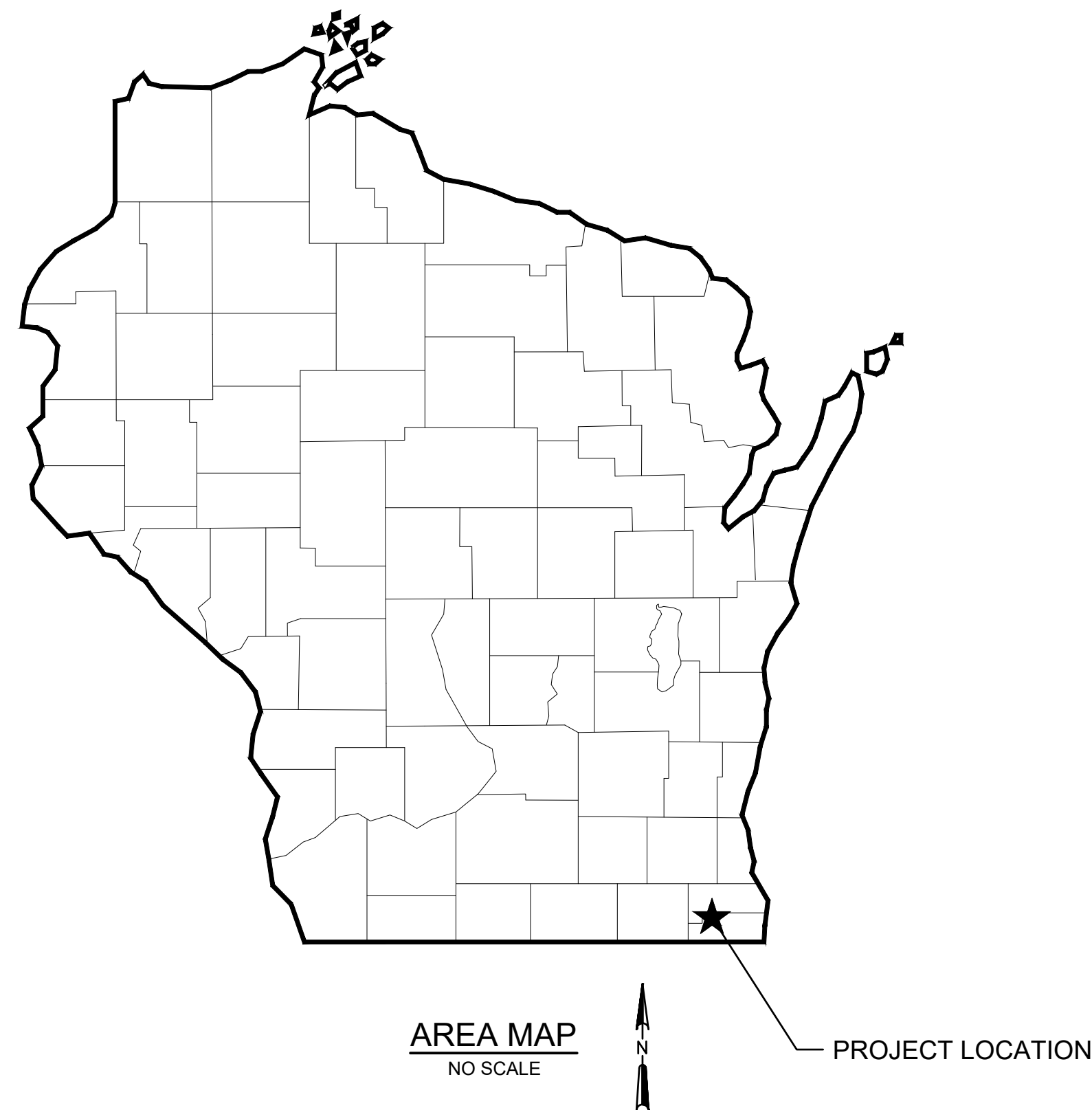

PROJECT LOCATION MAP  
NO SCALE

SHEET NO.	DRAWING LIST
1	TITLE SHEET
2	GENERAL NOTES
3	ALIGNMENT DETAIL
4-5	CONSTRUCTION DETAILS
6-8	PLAN AND PROFILES



*Isak P. Fruchtmann*  
10/10/2023

**Strand Associates, Inc.**  
126 North Jefferson Street  
Milwaukee, WI 53202  
414-271-0771  
www.strand.com

**CONTRACT 1-2023**

ISSUED FOR BID - 10/10/2023



SHEET  
1







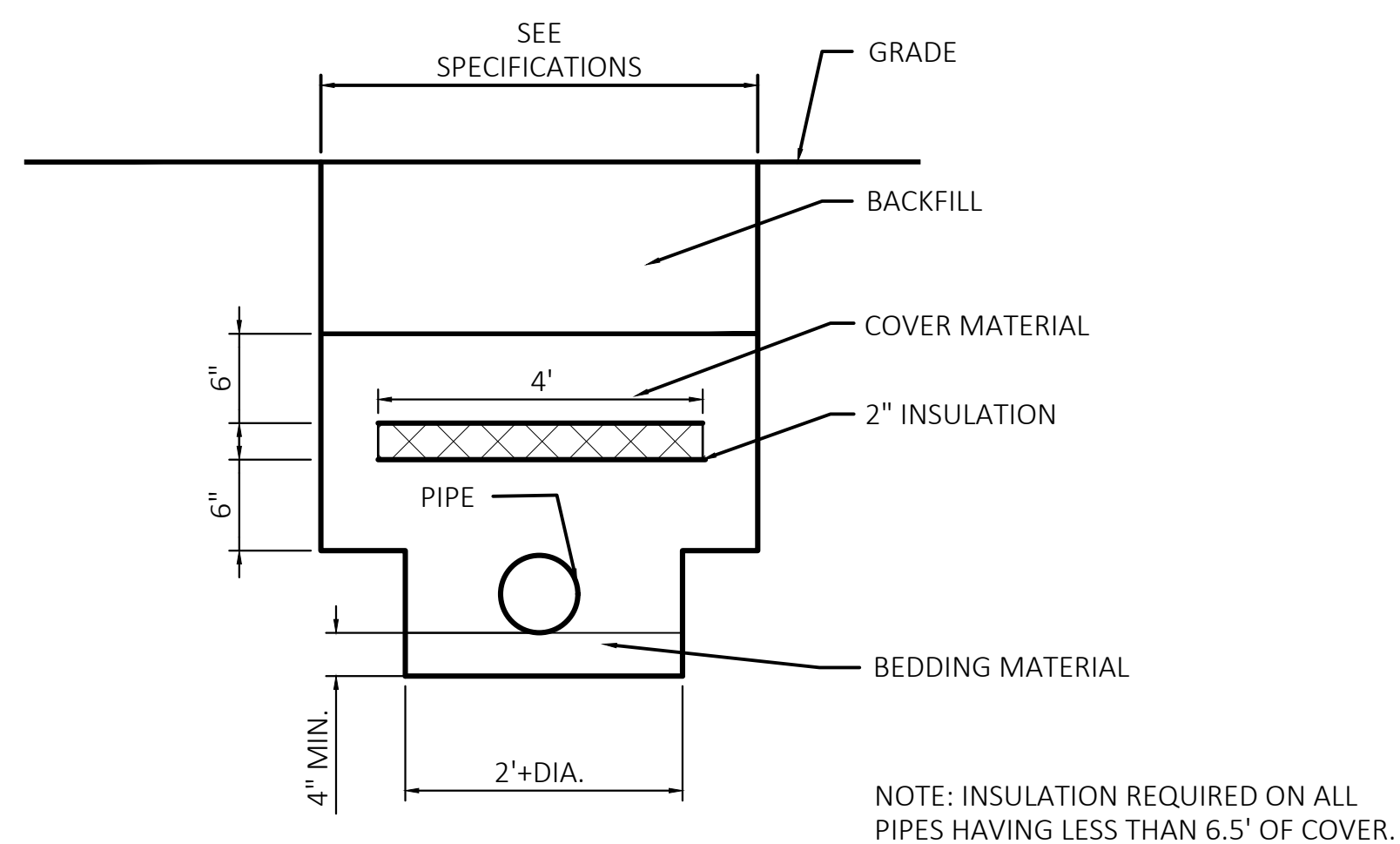

**A**  
5 UNDERGROUND PIPE INSULATION  
NO SCALE

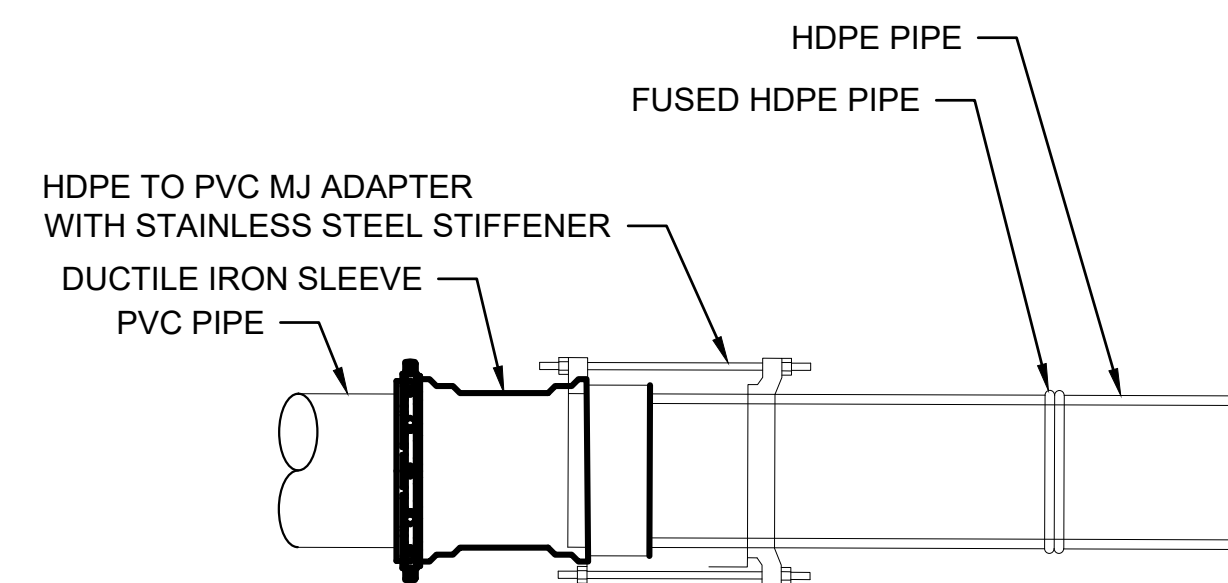

**B**  
5 PVC TO HDPE CONNECTION  
NO SCALE

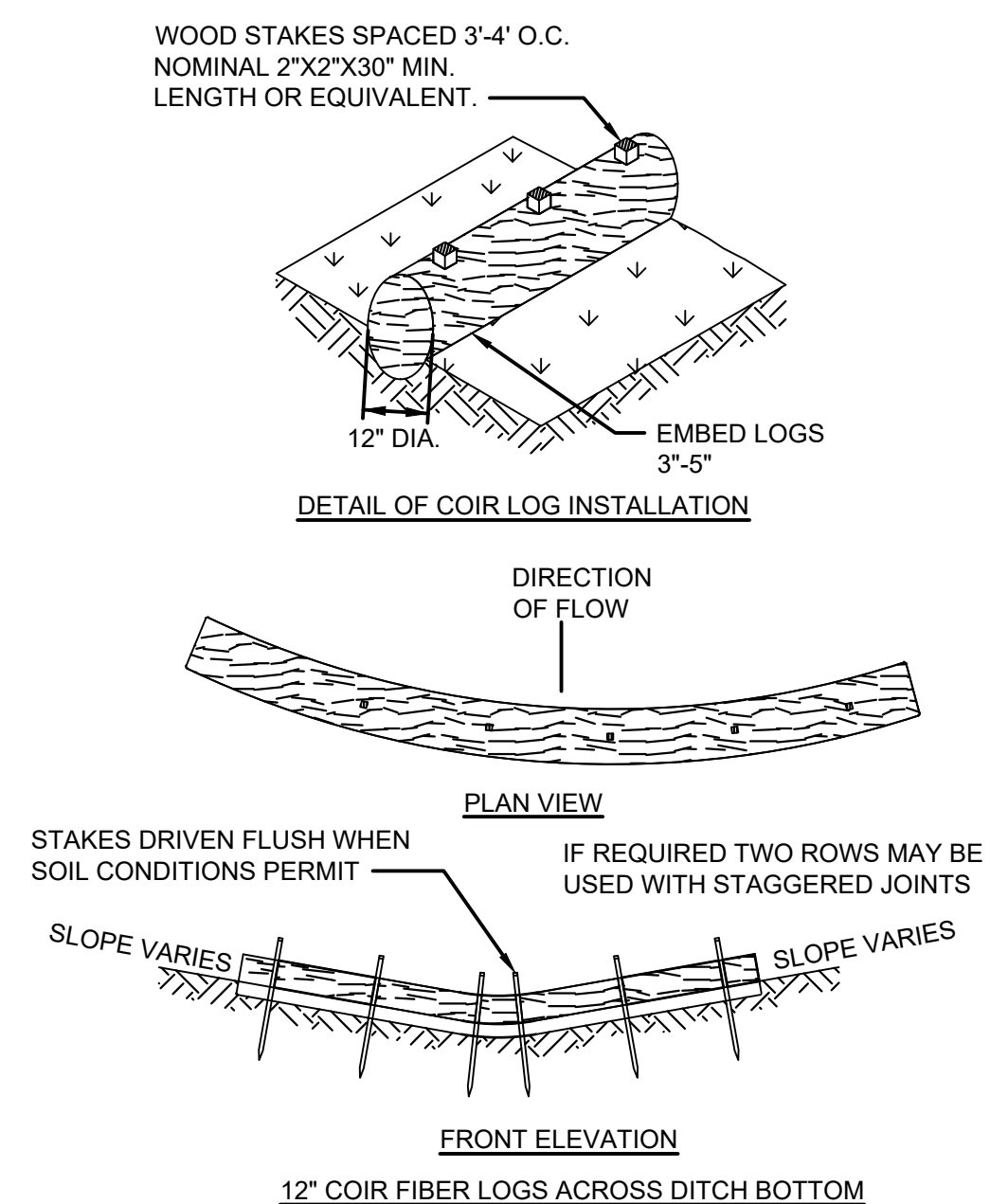

**C**  
5 STRAW WATTLE  
NO SCALE

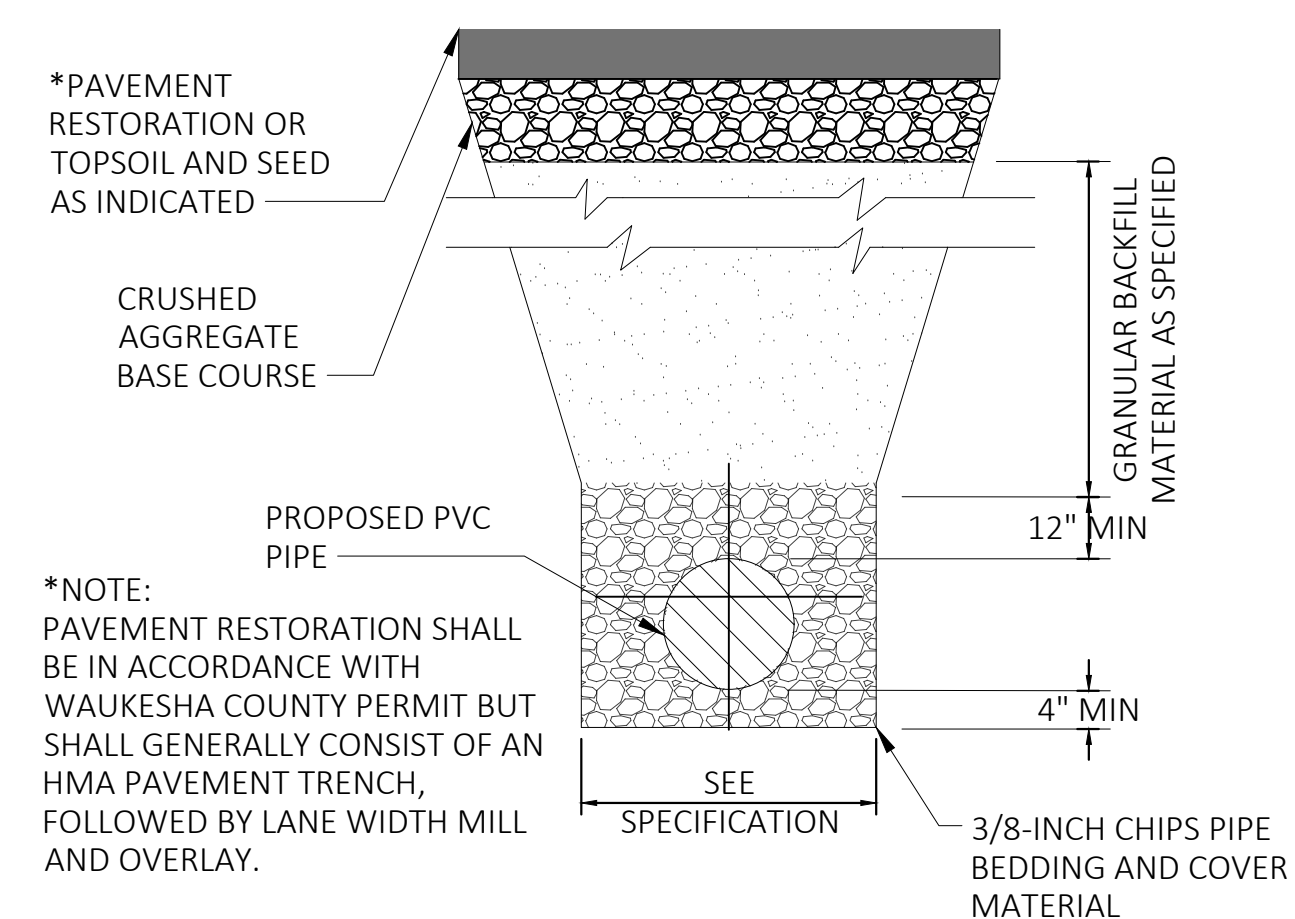

**D**  
5 TYPICAL TRENCH DETAIL  
NO SCALE

NO.	REVISIONS	DATE:

**CONSTRUCTION DETAILS**  
BRIGHTON DALE PARK FORCE MAIN REPLACEMENT  
KENOSHA COUNTY  
WISCONSIN

**JOB NO.**  
3569.009  
**PROJECT MGR.**  
IPF



**SHEET**  
5



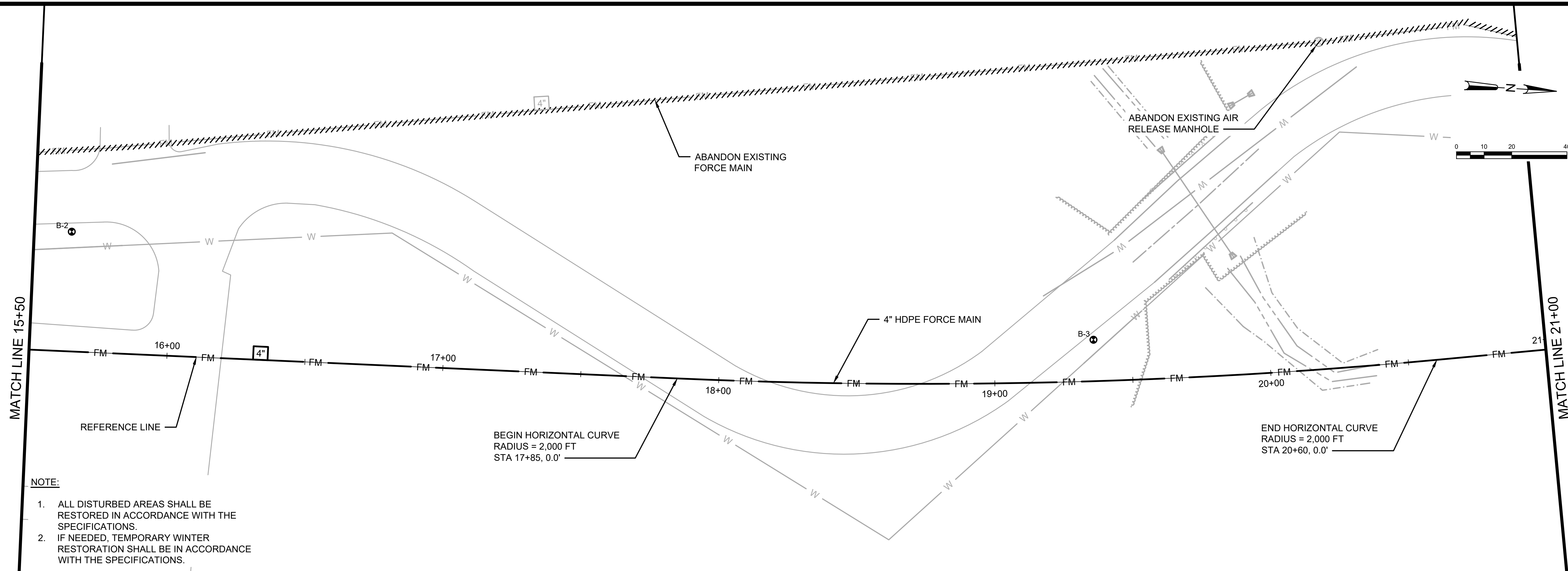

- NOTE:**
1. ALL DISTURBED AREAS SHALL BE RESTORED IN ACCORDANCE WITH THE SPECIFICATIONS.
  2. IF NEEDED, TEMPORARY WINTER RESTORATION SHALL BE IN ACCORDANCE WITH THE SPECIFICATIONS.

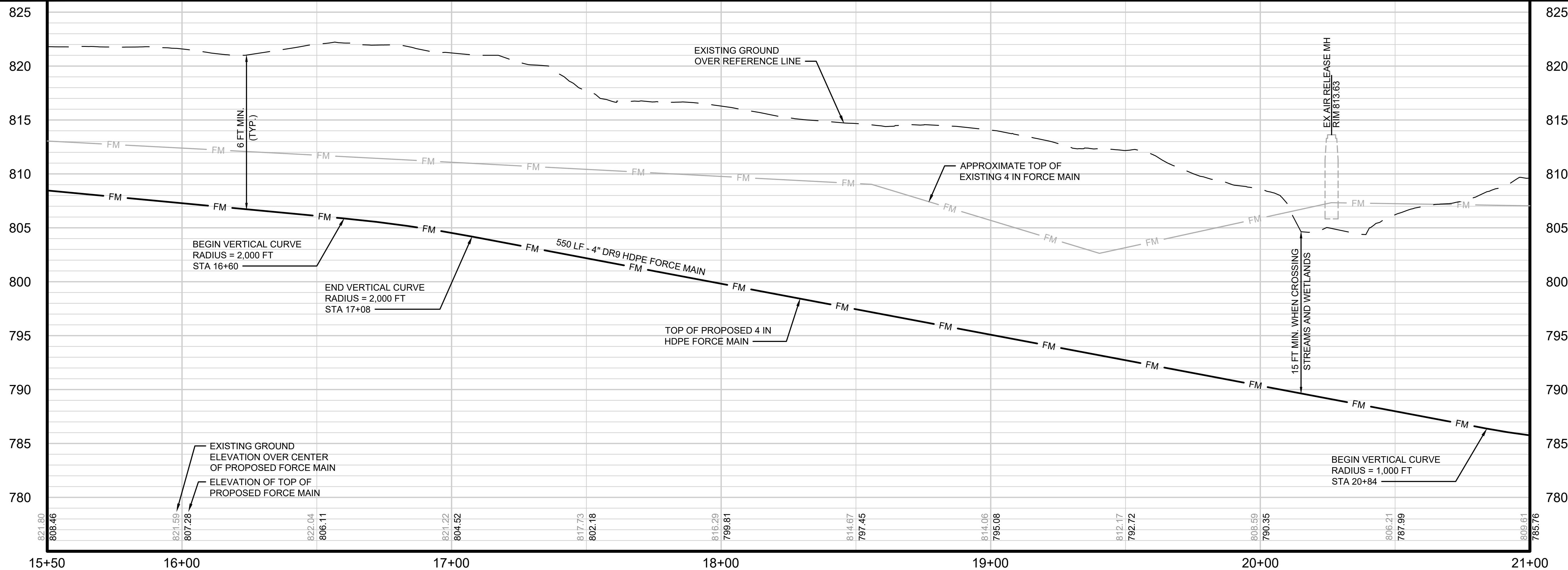

NO.	REVISIONS	DATE:

**PLAN AND PROFILE**

**BRIGHTON DALE PARK FORCE MAIN REPLACEMENT**

**KENOSHA COUNTY**

**WISCONSIN**

**JOB NO.**  
3569.009

**PROJECT MGR.**  
IPF



**SHEET**  
7

MATCH LINE 21+00

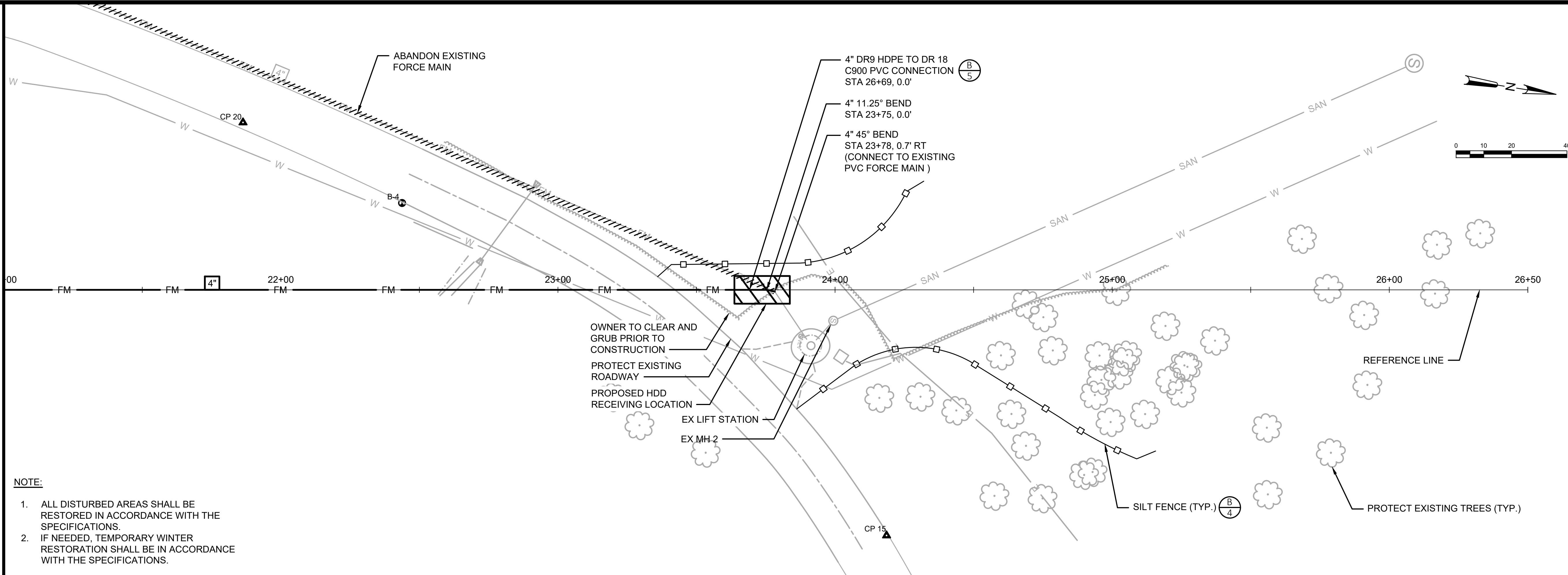

**NOTE:**

1. ALL DISTURBED AREAS SHALL BE RESTORED IN ACCORDANCE WITH THE SPECIFICATIONS.
2. IF NEEDED, TEMPORARY WINTER RESTORATION SHALL BE IN ACCORDANCE WITH THE SPECIFICATIONS.

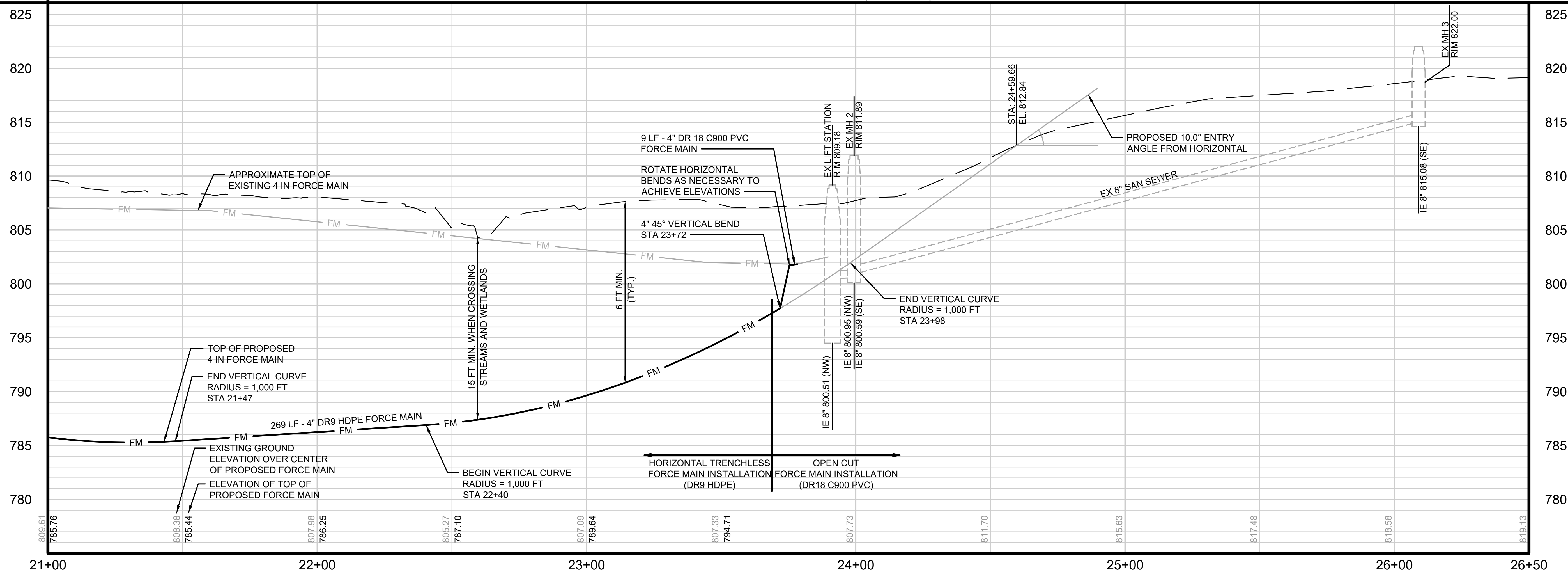

NO.	REVISIONS	DATE:

**PLAN AND PROFILE**  
**BRIGHTON DALE PARK FORCE MAIN REPLACEMENT**  
**KENOSHA COUNTY**  
**WISCONSIN**

**JOB NO.**  
3569.009  
**PROJECT MGR.**  
IPF



**SHEET**  
8